



## Dry Lower Mount Pressure, Vacuum & Compound Gauges

- A Durable Dry Type Utility Gauge for Commercial and Industrial Markets
- Suitable for Air, Water, Oil, Gas or Any Other Media Not Corrosive to Brass
- Other Connection Locations, Mounting Styles and Accessories Available

### Specifications:

Available Dial Sizes : 1-1/2", 2", 2- 1/2", 4-1/2"

Available Connection Sizes

1/8" NPT on 1-1/2" Dial Size

1/4" NPT on 2" Thru 4 - 1/2" Dial Sizes

- Black Steel Case, Chrome Plated Steel Bezel
- Copper Alloy Wetted Parts
- Polycarbonate Lens
- Accuracy 3-2-3 % of Span, ASME B40.1 Grade B
- Ambient Temperature: -50° F to 160° F
- Dual Scale PSI /Bar ( x 100= kPa ) Standard
- Design Meets or Exceeds ASME B40.100 Pressure Gauge Standard

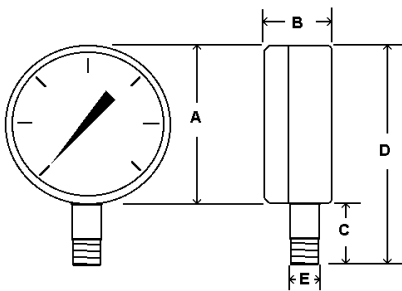

Range	Major Inc.	Minor Inc.
<b>Vacuum Gauges</b>		
30/0"VAC	5" hg	.5" hg
<b>Compound Gauges</b>		
30/0/15	10"hg / 5 psi	1"hg / .5 psi
30/0/30	10"hg / 10 psi	1"hg / 1 psi
30/0/60	10"hg / 10 psi	2"hg / 1 psi
30/0/100	30"hg / 20 psi	5"hg / 2 psi
30/0/150	30"hg / 20 psi	5"hg / 2 psi
30/0/300	30"hg / 50 psi	10"hg / 5 psi
<b>Pressure Gauges</b>		
0/15	2 psi	.1 psi
0/30	5 psi	.5 psi
0/60	10 psi	1 psi
0/100	20 psi	2 psi
0/160	20 psi	2 psi
0/200	40 psi	5 psi
0/300	50 psi	5 psi
0/400	50 psi	5 psi
0/600	100 psi	10 psi
0/1000	200 psi	20 psi
0/1500	200 psi	20 psi
0/2000	400 psi	50 psi
0/3000	500 psi	50 psi
0/4000	800 psi	100 psi
0/5000	1000 psi	100 psi
0/6000	1000 psi	100 psi

Dial Size	Pressure Gauges	Vacuum Gauges	Compound Gauges	A	B	C	D	E (MNPT)
1-1/2"	PSL15-PSI	VSL15-030	N/A	1.64	.93	.65	2.26	1/8"
2"	PSL20-PSI	VSL20-030	CGSL20-30PSI	2.07	1.06	.83	2.83	1/4"
2-1/2"	PSL25-PSI	VSL25-030	CGSL25-30PSI	2.50	1.13	.88	3.31	1/4"
4-1/2"	PSL45-PSI	VSL45-030	N/A	4.79	1.12	1.10	5.80	1/4"

Dimensions Shown in Inches

### Available Pressure Ranges

1-1/2" 15, 30, 60, 100, 160, 200, 300 & 600 psi

2" Same Pressure Ranges As Above Plus 400, 600, 1000, 1500, 2000 and 3000 psi

2-1/2" 15, 30, 60, 100, 160, 200, 300, 400, 600, 1000, 1500, 2000, 3000, 4000, 5000 and 6000 psi

4-1/2" 15, 30, 60, 100, 160, 200, 300, 400, 600, and 1000 psi

Note the CGSL20 Compound Gauge is Not Available in the 30/0/15 Range